

Z-VENT

Damper Assembly Supplemental Instructions[#]



The following flanged damper assemblies are designed for use with Z-Vent and are available in open/close (NON-modulating) with end switches OR open/close/MODULATING with pressure tap, pressure transducer and pressure setpoint controller. All assemblies include flanged to Z-Vent (male and female) adapters, high temperature RTV silicone damper flange sealant and two single wall flange clamps (4" flange clamps are included with damper, larger clamps are included with adapter kits, 2SVDMLLD__V includes an extra double wall flange clamp on male connection).

NON-Modulating: For use in common vent to prevent flue gas flow through non operating appliance.
MODULATING: For use in common vent to prevent flue gas flow through non operating appliance and/or to control excessive draft pressure at appliance outlet.

NON-Modulating Damper Assemblies:

Part Numbers	Single Wall	Installed Length
2SVSLLDA04	4" Diameter	12.625"
2SVSLLDA06	6" Diameter	12.625"
2SVSLLDA08	8" Diameter	12.625"
2SVSLLDA10	10" Diameter	12.625"
2SVSLLDA12	12" Diameter	12.625"
2SVSLLDA14	14" Diameter	13.625"
2SVSLLDA16	16" Diameter	15.625"

MODULATING Damper Assemblies:

Part Numbers	Single Wall	Installed Length
2SVSMLLDA04	4" Diameter	16.625"
2SVSMLLDA06	6" Diameter	16.625"
2SVSMLLDA08	8" Diameter	16.625"
2SVSMLLDA10	10" Diameter	16.625"
2SVSMLLDA12	12" Diameter	16.625"
2SVSMLLDA14	14" Diameter	17.625"
2SVSMLLDA16	16" Diameter	21.875"

Part Numbers	DW Snap	Installed Length
2SVDLLDA04	4" Diameter	20.625"
2SVDLLDA06	6" Diameter	20.625"
2SVDLLDA08	8" Diameter	20.625"
2SVDLLDA10	10" Diameter	20.625"
2SVDLLDA12	12" Diameter	20.625"
2SVDLLDA14	14" Diameter	21.625"
2SVDLLDA16	16" Diameter	23.625"

Part Numbers	DW Snap	Installed Length
2SVDMLLDA04	4" Diameter	24.625"
2SVDMLLDA06	6" Diameter	24.625"
2SVDMLLDA08	8" Diameter	24.625"
2SVDMLLDA10	10" Diameter	24.625"
2SVDMLLDA12	12" Diameter	24.625"
2SVDMLLDA14	14" Diameter	25.625"
2SVDMLLDA16	16" Diameter	29.875"

Part Numbers	DW ZV-Clamp	Installed Length
2SVDLLDA06V	6" Diameter	20.625"
2SVDLLDA08V	8" Diameter	20.625"
2SVDLLDA10V	10" Diameter	20.625"
2SVDLLDA12V	12" Diameter	20.625"
2SVDLLDA14V	14" Diameter	21.625"
2SVDLLDA16V	16" Diameter	23.625"

Part Numbers	DW ZV-Clamp	Installed Length
2SVDMLLDA06V	6" Diameter	24.625"
2SVDMLLDA08V	8" Diameter	24.625"
2SVDMLLDA10V	10" Diameter	24.625"
2SVDMLLDA12V	12" Diameter	24.625"
2SVDMLLDA14V	14" Diameter	25.625"
2SVDMLLDA16V	16" Diameter	29.875"

Part Numbers	Modulating Damper Accessories
2SVMLLDPS	120VAC to 24VDC Power Supply
2SVMLLDGFS	Differential Pressure Switch
2SVMLLDPSGFS	24VDC Power Supply & Differential Pressure Switch

Z-VENT

Damper Assembly Supplemental Instructions[#]



DEFINITIONS

WARNING

Indicates a potentially hazardous situation which, if ignored, can result in death, serious injury or substantial property damage.

WARNING

These instructions are to be used to supplement Veartis VB2 or VSD (modulating) and Z-Flex Z-Vent Installation Instructions. A Qualified installer must install venting system in accordance with all these instructions, local building codes or in absence of local codes latest edition of National Fuel Gas Code; ANSI Z223.1/NFPA 54 in USA or CAN/CGA-B 149.1 or .2 in Canada. Consult appliance manufacturer's installation instructions or Professional Engineer for venting system approval and to resolve any conflicts.

Z-Vent Adapter Male to Flange; 2SV(S,D)AMFLG__ (V) Instructions - See images on pages 3 & 4

1. Follow Veartis Installation Instructions included with damper to ensure vent layout positions damper in proper orientation and spacing. NOTE: Condensing applications require inline vent drain (sold separately) on damper outlet.
2. Follow [Z-Vent Special Gas Vent Installation Guide](#) to install male end of Z-Vent adapter to outlet of mating Z-Vent pipe or fitting.
3. Apply continuous bead approximately 3/16" diameter of included high temperature RTV silicone flange sealant to adapter outlet flat flange surface.
4. In proper orientation, align outer edges of flanges and install damper inlet flange on Z-Vent adapter flange outlet, press firmly to compress silicone sealant.
5. Smooth sealant around flanges, apply more sealant if required.
6. Install flange clamp over mating adapter/damper flanges and snugly tighten all clamp band bolts/nuts to 30in/lbs.

Z-Vent Adapter Flange to Female; 2SV(S,D)AFLGF__ (V) Instructions - See images on pages 3 & 4

1. Apply continuous bead approximately 3/16" diameter of included high temperature RTV silicone flange sealant to damper outlet flat flange surface.
2. Align outer edges of flanges and install Z-Vent adapter inlet flange on damper outlet flange, press firmly to compress silicone sealant.
3. Smooth sealant around flanges, apply more sealant if required.
4. Install flange clamp over mating damper/adapter flanges and snugly tighten all clamp band bolts/nuts to 30in/lbs.
5. Follow [Z-Vent Special Gas Vent Installation Guide](#) to install female end of Z-Vent adapter to inlet of mating Z-Vent pipe or fitting.

Z-VENT

Damper Assembly Supplemental Instructions#



Z-Vent Single Wall Damper Assembly; 2SVSLLD(M)_ _

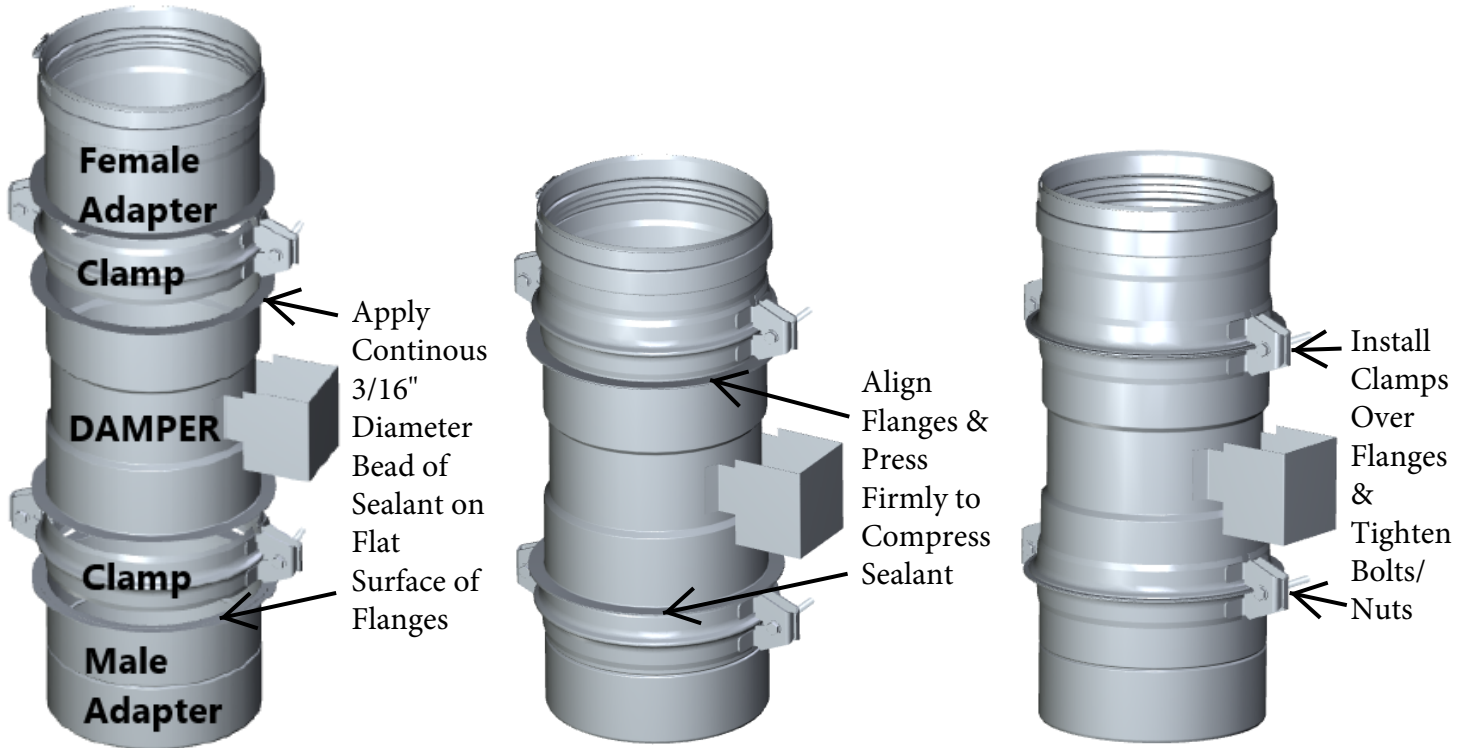

Z-Vent Double Wall Snap Lock Damper Assembly; 2SVD(M)LLD_ _

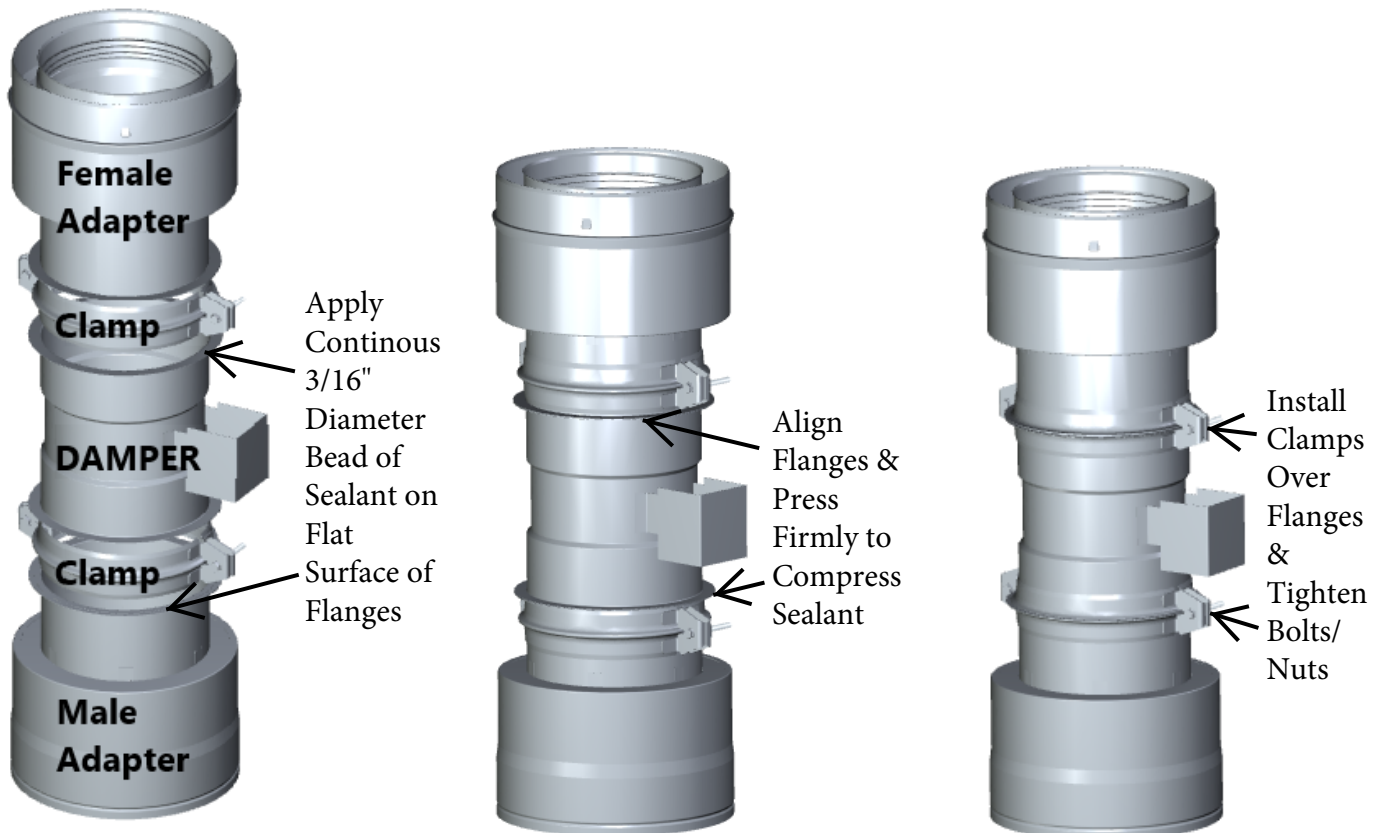

Z-VENT

Damper Assembly Supplemental Instructions#



Z-Vent Double Wall ZV-Clamp Damper Assembly; 2SVD(M)LLD__V

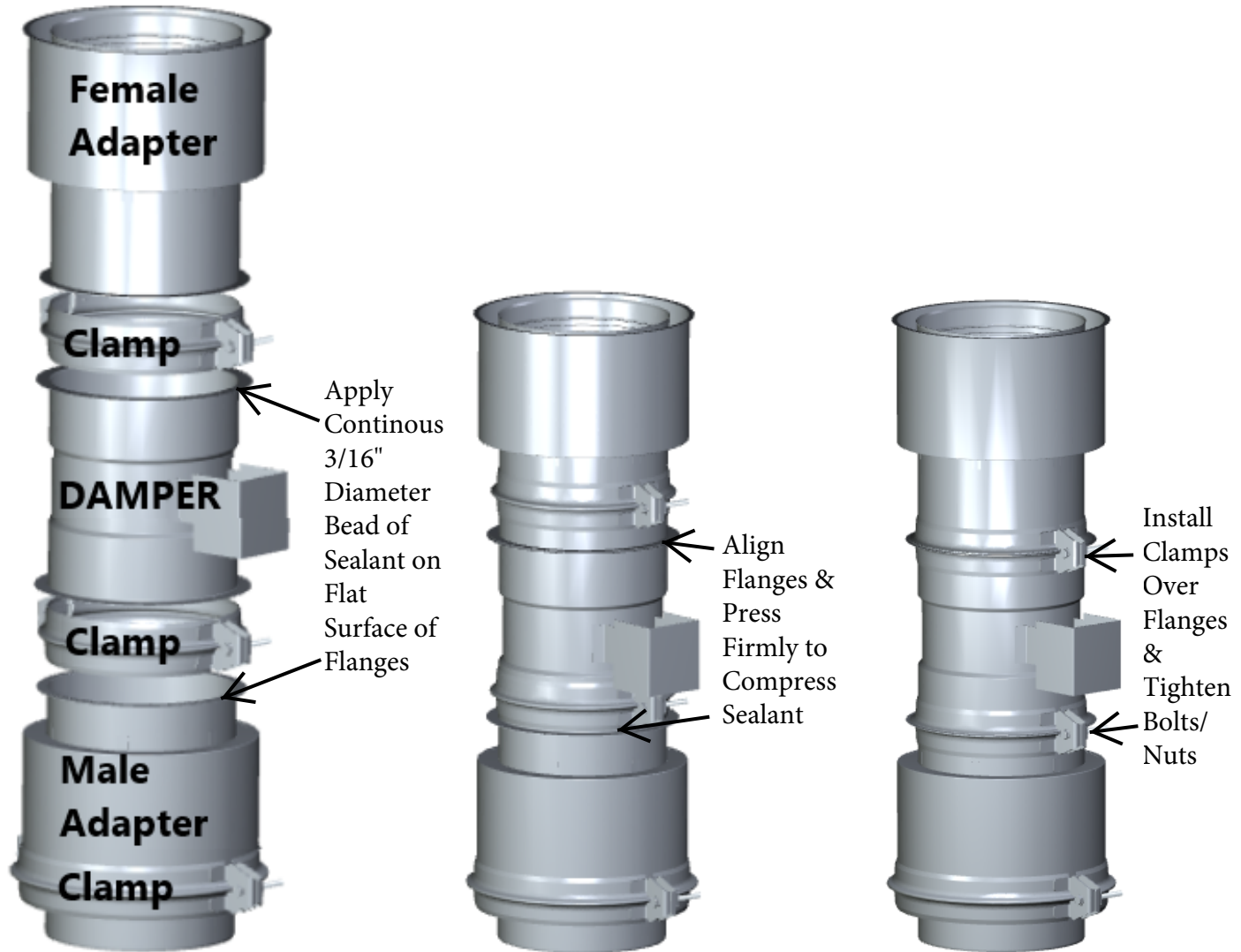

The information provided within is for informational purposes only. We have made every effort to ensure the accuracy of the provided information and assume no responsibility for any loss or damage due to errors or omissions or to the use or misuse of any information supplied. It is impossible to test all products under all conditions to which they might be subjected in the field. It is therefore the buyer and/or end users' responsibility to test all products under the conditions that duplicate the service conditions prior to installation. All improvements, all specifications are subject to change without prior notice. It is the buyer and/or end users' responsibility to review our complete Terms and Conditions of Sale located on our web sites at: www.novaflex.com | www.z-flex.com | www.flexmaster.com.

- # Information subject to change without notice.
- # Install carbon monoxide detector and alarms in accordance with local codes.
- # Contact Z-Flex for any additional information.

Canada: 452 Attwell Drive, Etobicoke, ON M9W 5C3 tel: 416.679.0045 • fax: 416.679.0051
USA: 20 Commerce Park North, Bedford, New Hampshire tel: 603.669.5136 800.654.5600 • fax: 603.669.0309

0INSTZVDAMPER rev 11.2021